

C.I.P.**22 Hornet**

Pays d'origine: US

TAB. II

Date 84-06-14

Révision 02-05-15

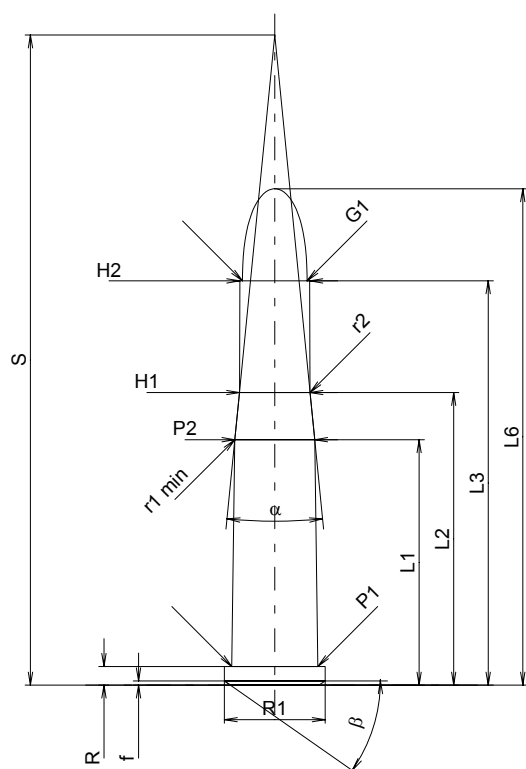
**CARTOUCHE MAXI****Longueurs**

L1	=	21.64
L2	=	25.80
L3 ¹⁾	=	35.64
L4	=	
L5	=	
L6	=	43.76

Culot

R ¹⁾	=	1.65	-0.25
R1	=	8.89	
R3	=		
E	=		
E1	=		
e min	=		
delta	=		
f	=	0.38	
beta	=	35°	

Chambre à poudre

P1	=	7.59
P2*	=	7.04

Cône de raccordement

alpha*	=	11°16'
S*	=	57.33
r1 min	=	12.70
r2	=	22.23

Collet

H1*	=	6.22
H2 ¹⁾	=	6.16

Projectile

G1 ¹⁾	=	5.70
G2	=	
F	=	
L3+G ¹⁾	=	38.78

Pressions (Énergies)**Méthode transducteur**

Pmax	=	3000 bar
PK	=	3450 bar
PE	=	3750 bar
M	=	17.50
EE	=	1055 Joule

Autres indications

Fe ¹⁾	=	0.15
delta L	=	

CHAMBRE MINI**Longueurs**

L1	=	21.44
L2	=	25.81
L3 ¹⁾	=	35.76

Cuvette

R ¹⁾	=	1.65
R1	=	9.14
R2	=	
R3	=	
r	=	

Chambre à poudre

E	=	
P1 ¹⁾	=	7.62
P2*	=	7.07

Cône de raccordement

alpha*	=	10°58'01"
S*	=	58.26
r1 max	=	12.70
r2	=	22.23

Collet

H1*	=	6.23
H2 ¹⁾	=	6.17

Prise de rayures

G1 ¹⁾ *	=	5.82
G ¹⁾	=	3.14
alpha1*	=	90°
h	=	0.18
s	=	
i ¹⁾ *	=	3°
w	=	

Canon

F ¹⁾ *	=	5.51
Z ¹⁾	=	5.64

Rayures

b	=	1.73
N	=	6
u	=	406.00
Q	=	24.53 mm ²

Échelle 1.5:1

Dimensions en << mm >>
Dimensions et tolérances pour les canons
d'épreuve: Voyez Annexe CR 1.

Notes: 1) A' contrôler pour la sécurité
* Dimensions de base