

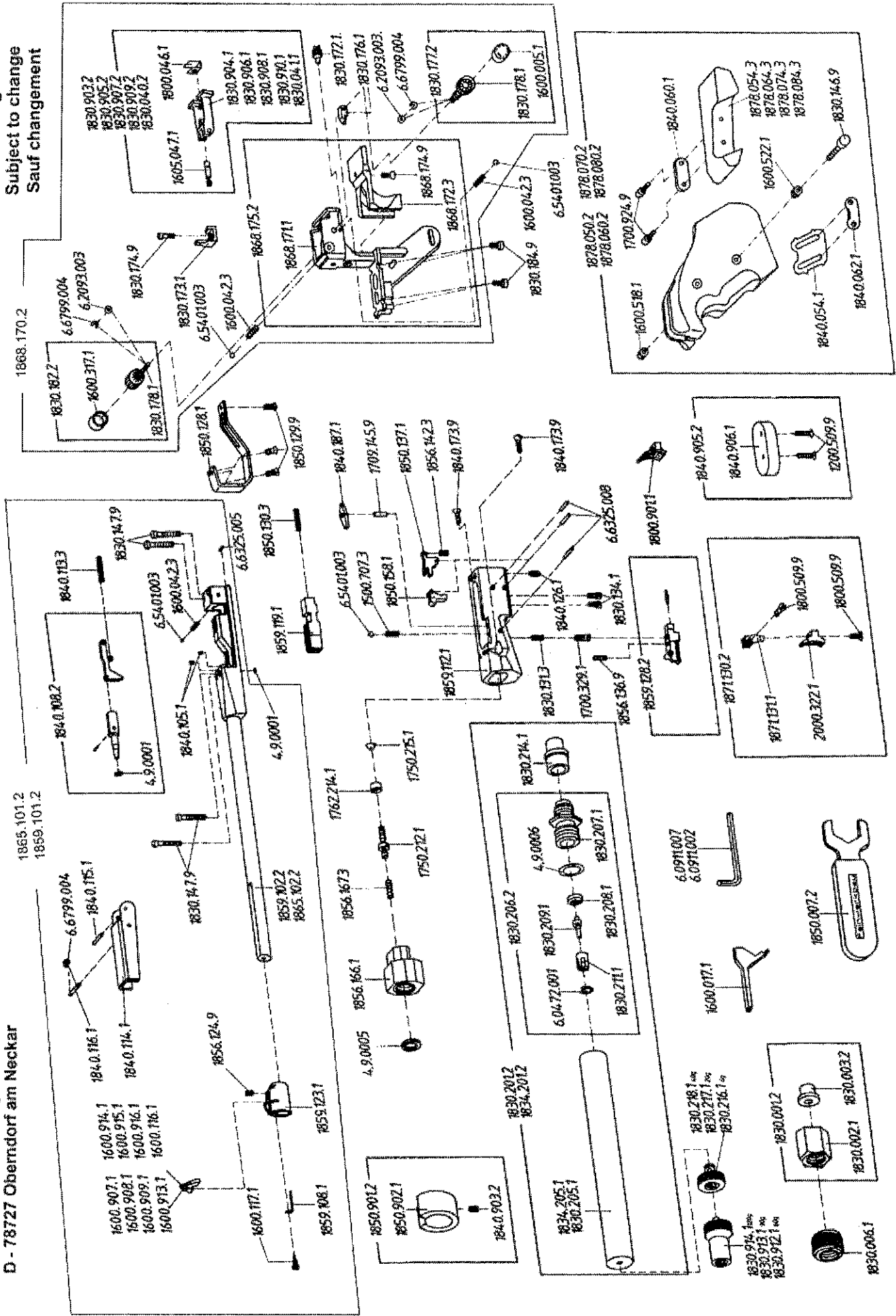

Feinwerkbau
Westinger & Altenburger GmbH
D - 78727 Oberndorf am Neckar

Luftpistole Modell C20

1855.101.2
1859.101.2



Stand: März 1995 (ex)
Technische Änderungen vorbehalten
Subject to change
Sauf changement

1855.101.2
1859.101.2

1830.182.2
1830.178.1
1830.177.1
6.6799.004
6.2093.003
1830.174.9
1830.173.1
6.54.01.003
1830.172.3
1830.175.2
1868.171.1
1868.172.3
1868.174.9
1830.184.9
1600.04.2.3
6.54.01.003

1830.903.2
1830.905.2
1830.907.2
1830.909.2
1830.904.0.2
1800.04.6.1
1830.904.1
1830.906.1
1830.908.1
1830.910.1
1830.04.1.1

1830.172.1
1830.176.1
6.2093.003
6.6799.004
1830.177.2
1600.005.1

1878.05.0.2
1878.06.0.2
1878.08.0.2
1700.924.9
184.0.060.1
1878.054.3
1878.064.3
1878.074.3
1878.084.3
1600.518.1
1600.522.1
1600.062.1
1830.14.6.9

1850.128.1
1850.129.9
1840.187.1
1709.14.5.9
1850.157.1
1856.14.2.3
1840.173.9
1840.173.9

1840.188.1
1709.14.5.9
1850.157.1
1856.14.2.3
1840.173.9
1840.173.9

1840.188.1
1709.14.5.9
1850.157.1
1856.14.2.3
1840.173.9
1840.173.9

1840.188.1
1709.14.5.9
1850.157.1
1856.14.2.3
1840.173.9
1840.173.9

1840.188.1
1709.14.5.9
1850.157.1
1856.14.2.3
1840.173.9
1840.173.9

1840.188.1
1709.14.5.9
1850.157.1
1856.14.2.3
1840.173.9
1840.173.9

1840.188.1
1709.14.5.9
1850.157.1
1856.14.2.3
1840.173.9
1840.173.9

1840.188.1
1709.14.5.9
1850.157.1
1856.14.2.3
1840.173.9
1840.173.9

1840.188.1
1709.14.5.9
1850.157.1
1856.14.2.3
1840.173.9
1840.173.9

1840.188.1
1709.14.5.9
1850.157.1
1856.14.2.3
1840.173.9
1840.173.9

1840.188.1
1709.14.5.9
1850.157.1
1856.14.2.3
1840.173.9
1840.173.9

1840.188.1
1709.14.5.9
1850.157.1
1856.14.2.3
1840.173.9
1840.173.9

1840.188.1
1709.14.5.9
1850.157.1
1856.14.2.3
1840.173.9
1840.173.9

1840.188.1
1709.14.5.9
1850.157.1
1856.14.2.3
1840.173.9
1840.173.9

1840.188.1
1709.14.5.9
1850.157.1
1856.14.2.3
1840.173.9
1840.173.9

1840.188.1
1709.14.5.9
1850.157.1
1856.14.2.3
1840.173.9
1840.173.9

1840.188.1
1709.14.5.9
1850.157.1
1856.14.2.3
1840.173.9
1840.173.9

1840.188.1
1709.14.5.9
1850.157.1
1856.14.2.3
1840.173.9
1840.173.9

1840.188.1
1709.14.5.9
1850.157.1
1856.14.2.3
1840.173.9
1840.173.9

1840.188.1
1709.14.5.9
1850.157.1
1856.14.2.3
1840.173.9
1840.173.9

1840.188.1
1709.14.5.9
1850.157.1
1856.14.2.3
1840.173.9
1840.173.9