

C.I.P.**8 x 57 IRS**

TAB.

II

Date

84-06-14

Révision

16-05-18

Pays d'origine: DE

Marquage alternatif: 8 x 57 JRS

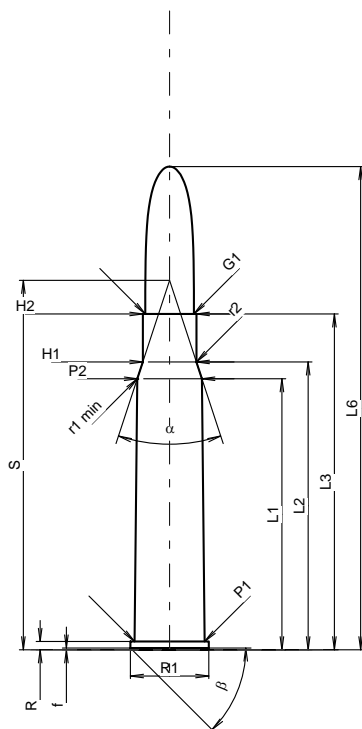
**CARTOUCHE MAXI****Longueurs**

L1 *	=	46.00
L2 *	=	48.85
L3 ¹⁾	=	57.00
L4	=	
L5	=	
L6	=	82.00

Culot

R ¹⁾	=	1.40	-0.25
R1	=	13.32	
R3	=		
E	=		
E1	=		
e min	=		
delta	=		
f	=	0.30	
beta	=	45°	

Chambre à poudre

P1	=	11.92
P2 *	=	10.95

Cône de raccordement

alpha	=	36°19'34"
S	=	62.69
r1 min	=	0.50
r2	=	0.50

Collet

H1 *	=	9.08
H2 ¹⁾	=	9.08

Projectile

G1 ¹⁾	=	8.22
G2	=	
F	=	
L3+G ¹⁾	=	92.00

Pressions (Énergies)**Méthode transducteur**

Pmax	=	3300 bar
PK	=	3795 bar
PE	=	4125 bar
M	=	25.00
EE	=	3955 Joule

Autres indications

Fe ¹⁾⁴⁾	=	0.15
delta L	=	

CHAMBRE MINI**Longueurs**

L1 *	=	46.00
L2 *	=	48.85
L3 ¹⁾	=	57.30

Cuvette

R ¹⁾	=	1.40
R1	=	13.37
R2	=	
R3	=	
r	=	

Chambre à poudre

E	=	
P1 ¹⁾	=	11.95
P2 *	=	10.98

Cône de raccordement

alpha	=	36°19'34"
S	=	62.73
r1 max	=	0.50
r2	=	0.50

Collet

H1 *	=	9.11
H2 ¹⁾	=	9.10

Prise de rayures

G1 ¹⁾ *	=	8.24
G ¹⁾ *	=	35.00
alpha1	=	180°
h	=	
s	=	
i ¹⁾	=	0°17'11"
w	=	

Canon

F ¹⁾ *	=	7.89
Z ¹⁾	=	8.20

Rayures

b	=	4.40
N	=	4
u	=	240.00
Q	=	51.78 mm ²

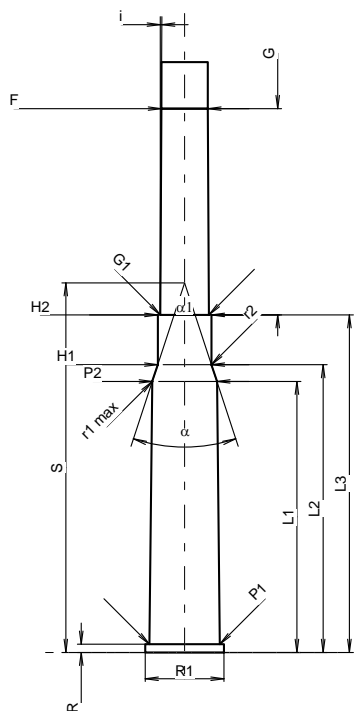

Échelle 1:1.28

Dimensions en << mm >>
Dimensions et tolérances pour les canons
d'épreuve: Voyez Annexe CR 1.

Notes: 1) A' contrôler pour la sécurité
4) Feuillure sur la bourrelet
* Dimensions de base

C.I.P.**8 x 57 IS**

TAB.

I

Date

84-06-14

Révision

16-05-18

Pays d'origine: DE

Marquage alternatif: 8 x 57 JS

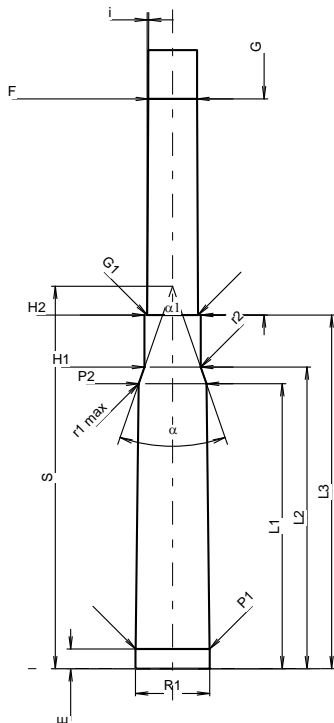
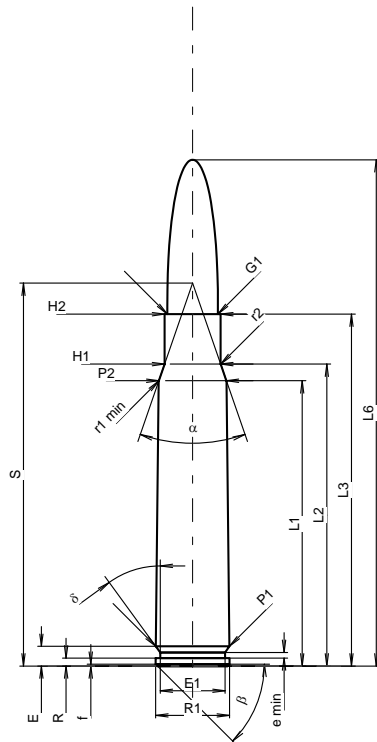

Échelle 1:1.22

Dimensions en << mm >>
Dimensions et tolérances pour les canons
d'épreuve: Voyez Annexe CR 1.

CARTOUCHE MAXI**Longueurs**

L1 ¹⁾ *	=	46.20	-0.20
L2 ¹⁾ *	=	48.90	-0.20
L3 ¹⁾	=	57.00	
L4	=		
L5	=		
L6	=	82.00	

Culot

R	=	1.30	
R1	=	11.95	
R3	=		
E	=	3.19	
E1	=	10.50	
e min	=	0.90	
delta	=	36°	
f	=	0.30	
beta	=	45°	

Chambre à poudre

P1	=	11.94	
P2 ¹⁾ *	=	10.95	-0.20

Cône de raccordement

alpha	=	38°12'06"	
S	=	62.01	
r1 min	=	0.50	
r2	=	0.50	

Collet

H1 *	=	9.08	
H2 ¹⁾	=	9.08	

Projectile

G1 ¹⁾	=	8.22	
G2	=		
F	=		
L3+G ¹⁾	=	92.00	

Pressions (Énergies)**Méthode transducteur**

Pmax	=	3900 bar	
PK	=	4485 bar	
PE	=	4875 bar	
M	=	25.00	
EE	=	4300 Joule	

Autres indications

Fe ¹⁾³⁾	=	0.10	
delta L	=		

CHAMBRE MINI**Longueurs**

L1 *	=	46.16	
L2 *	=	48.85	
L3 ¹⁾	=	57.30	

Cuvette

R	=	1.30	
R1	=	12.00	
R2	=		
R3	=		
r	=		

Chambre à poudre

E	=	3.19	
P1 ¹⁾	=	11.97	
P2 *	=	10.98	

Cône de raccordement

alpha ¹⁾	=	38°20'	
S	=	61.95	
r1 max	=	0.50	
r2	=	0.50	

Collet

H1 *	=	9.11	
H2 ¹⁾	=	9.10	

Prise de rayures

G1 ¹⁾ *	=	8.24	
G ¹⁾ *	=	35.00	
alpha l	=	180°	
h *	=		
s	=		
i ¹⁾	=	0°17'11"	
w	=		

Canon

F ¹⁾ *	=	7.89	
Z ¹⁾	=	8.20	

Rayures

b	=	4.40	
N	=	4	
u	=	240.00	
Q	=	51.78	mm ²

Notes: 1) A' contrôler pour la sécurité
3) Feuillure sur la cone de raccordement
* Dimensions de base

C.I.P.**8 x 60 S**

TAB.

I

Date

84-06-14

Révision

06-09-19

Pays d'origine: DE

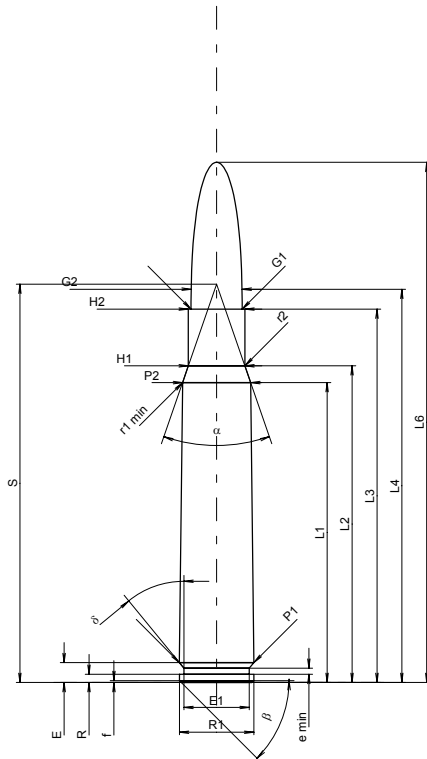
**CARTOUCHE MAXI****Longueurs**

L1 ¹⁾ *	=	48.20	-0.20
L2 ¹⁾ *	=	50.90	-0.20
L3 ¹⁾	=	60.00	
L4	=	63.20	
L5	=		
L6	=	83.60	

Culot

R	=	1.30	
R1	=	11.95	
R3	=		
E	=	3.20	
E1	=	10.50	
e min	=	1.00	
delta	=	39°25'48"	
f	=	0.30	
beta	=	45°	

Chambre à poudre

P1	=	11.98	
P2 ¹⁾ *	=	10.95	-0.20

Cône de raccordement

alpha	=	38°12'06"	
S	=	64.01	
r1 min	=	0.50	
r2	=	0.50	

Collet

H1 [*]	=	9.08	
H2 ¹⁾	=	9.08	

Projectile

G1 ¹⁾	=	8.22	
G2	=	8.18	
F	=		
L3+G ¹⁾	=	94.00	

Pressions (Énergies)**Méthode transducteur**

Pmax	=	4050 bar	
PK	=	4658 bar	
PE	=	5060 bar	
M	=	25.00	
EE	=	4285 Joule	

Autres indications

Fe ¹⁾	=	0.10	
delta L	=		

CHAMBRE MINI**Longueurs**

L1 [*]	=	48.16	
L2 [*]	=	50.85	
L3 ¹⁾	=	60.30	

Cuvette

R	=	1.30	
R1	=	12.00	
R2	=		
R3	=		
r	=		

Chambre à poudre

E	=	3.20	
P1	=	12.01	
P2 ¹⁾	=	10.98	

Cône de raccordement

alpha ¹⁾	=	38°20'	
S	=	63.95	
r1 max	=	0.50	
r2	=	0.50	

Collet

H1 [*]	=	9.11	
H2 ¹⁾	=	9.10	

Prise de rayures

G1 ¹⁾ *	=	8.23	
G ¹⁾ *	=	34.00	
alpha l	=	180°	
h	=		
s	=		
i ¹⁾	=	0°17'11"	
w	=		

Canon

F ¹⁾ *	=	7.89	
Z ¹⁾	=	8.20	

Rayures

b	=	4.40	
N	=	4	
u	=	240.00	
Q	=	51.78	mm ²

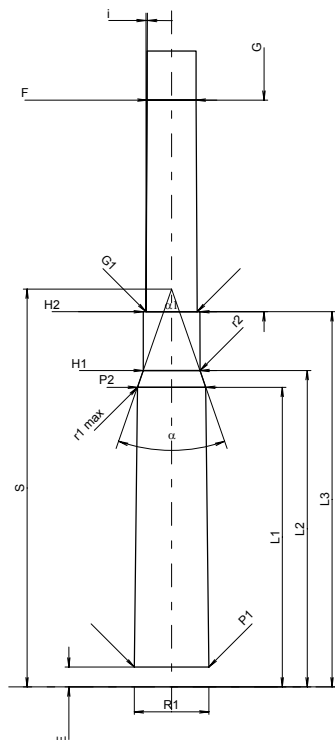

Échelle 1:1.21

Dimensions en << mm >>
Dimensions et tolérances pour les canons
d'épreuve: Voyez Annexe CR 1.

Notes: 1) A' contrôler pour la sécurité
* Dimensions de base

C.I.P.**8 x 64 S**

TAB.

I

Date

84-06-14

Révision

02-05-15

Pays d'origine: DE

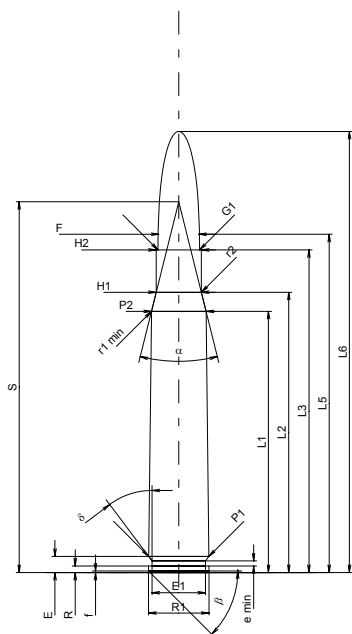
**CARTOUCHE MAXI****Longueurs**

L1 ¹⁾ *	=	51.80	-0.20
L2 ¹⁾ *	=	55.59	-0.20
L3 ¹⁾	=	64.00	
L4	=		
L5	=	67.10	
L6	=	87.50	

Culot

R	=	1.30	
R1	=	12.00	
R3	=		
E	=	3.20	
E1	=	10.60	
e min	=	1.00	
delta	=	36°48'	
f	=	0.30	
beta	=	45°	

Chambre à poudre

P1	=	11.95	
P2 ¹⁾ *	=	10.85	-0.20

Cône de raccordement

alpha	=	28°00'05"	
S	=	73.56	
r1 min	=	0.50	
r2	=	0.50	

Collet

H1 *	=	8.96	
H2 ¹⁾	=	8.96	

Projectile

G1 ¹⁾	=	8.22	
G2	=	8.18	
F	=		
L3+G ¹⁾	=	98.00	

Pressions (Énergies)**Méthode transducteur**

Pmax	=	4050 bar	
PK	=	4658 bar	
PE	=	5060 bar	
M	=	25.00	
EE	=	4595 Joule	

Autres indications

Fe ¹⁾	=	0.10	
delta L	=		

CHAMBRE MINI**Longueurs**

L1 *	=	51.74	
L2 *	=	55.53	
L3 ¹⁾	=	64.30	

Cuvette

R	=	1.30	
R1	=	12.05	
R2	=		
R3	=		
r	=		

Chambre à poudre

E	=	3.20	
P1 ¹⁾	=	11.98	
P2 *	=	10.88	

Cône de raccordement

alpha ¹⁾	=	28°00'03"	
S	=	73.56	
r1 max	=	0.50	
r2	=	0.50	

Collet

H1 *	=	8.99	
H2 ¹⁾	=	8.98	

Prise de rayures

G1 ¹⁾ *	=	8.23	
G ¹⁾ *	=	34.00	
alpha1	=	180°	
h	=		
s	=		
i ¹⁾	=	0°17'11"	
w	=		

Canon

F ¹⁾ *	=	7.89	
Z ¹⁾	=	8.20	

Rayures

b	=	4.40	
N	=	4	
u	=	240.00	
Q	=	51.78	mm ²

Échelle 1:1.5

Dimensions en << mm >>
Dimensions et tolérances pour les canons
d'épreuve: Voyez Annexe CR 1.

Notes: 1) A' contrôler pour la sécurité
* Dimensions de base

C.I.P.**8 x 68 S****TAB.****I****Date****84-06-14****Révision****06-09-19**

Pays d'origine: DE

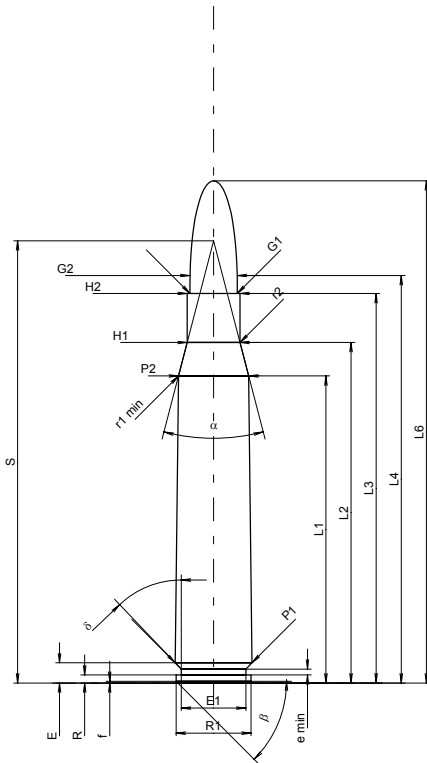
**CARTOUCHE MAXI****Longueurs**

L1 ¹⁾ *	=	53.20	-0.20
L2 ¹⁾ *	=	59.00	-0.20
L3 ¹⁾	=	67.50	
L4	=	70.60	
L5	=		
L6	=	87.00	

Culot

R	=	1.40	
R1	=	13.00	
R3	=		
E	=	3.50	
E1	=	11.20	
e min	=	1.00	
delta	=	43°42'	
f	=	0.30	
beta	=	45°	

Chambre à poudre

P1	=	13.30	
P2 ¹⁾ *	=	12.15	-0.20

Cône de raccordement

alpha	=	29°05'34"	
S	=	76.61	
r1 min	=	0.50	
r2	=	0.50	

Collet

H1 *	=	9.14	
H2 ¹⁾	=	9.14	

Projectile

G1 ¹⁾	=	8.22	
G2	=	8.18	
F	=		
L3+G ¹⁾	=	101.50	

Pressions (Énergies)**Méthode transducteur**

Pmax	=	4400 bar	
PK	=	5060 bar	
PE	=	5500 bar	
M	=	25.00	
EE	=	5975 Joule	

Autres indications

Fe ¹⁾	=	0.10	
delta L	=		

CHAMBRE MINI**Longueurs**

L1 *	=	53.14	
L2 *	=	58.94	
L3 ¹⁾	=	67.80	

Cuvette

R	=	1.40	
R1	=	13.05	
R2	=		
R3	=		
r	=		

Chambre à poudre

E	=	3.50	
P1 ¹⁾	=	13.33	
P2 *	=	12.18	

Cône de raccordement

alpha ¹⁾	=	29°05'34"	
S	=	76.61	
r1 max	=	0.50	
r2	=	0.50	

Collet

H1 *	=	9.17	
H2 ¹⁾	=	9.16	

Prise de rayures

G1 ¹⁾ *	=	8.23	
G ¹⁾ *	=	34.00	
alpha l	=	180°	
h	=		
s	=		
i ¹⁾	=	0°17'11"	
w	=		

Canon

F ¹⁾ *	=	7.89	
Z ¹⁾	=	8.20	

Rayures

b	=	4.40	
N	=	4	
u	=	280.00	
Q	=	51.78	mm ²

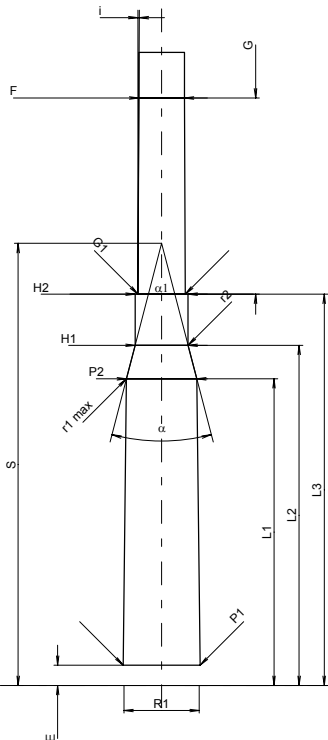

Échelle 1:1.31

Dimensions en << mm >>
Dimensions et tolérances pour les canons
d'épreuve: Voyez Annexe CR 1.

Notes: 1) A' contrôler pour la sécurité
* Dimensions de base